

**File name:**

X23-575\_867\_603\_\_\_GEO\_EN\_005\_\_\_RVTO\_MARCO\_LUNETTA\_\_B-GUSS\_KW29\_\_\_170714\_SE376\_ACC\_141020\_003.CATPart

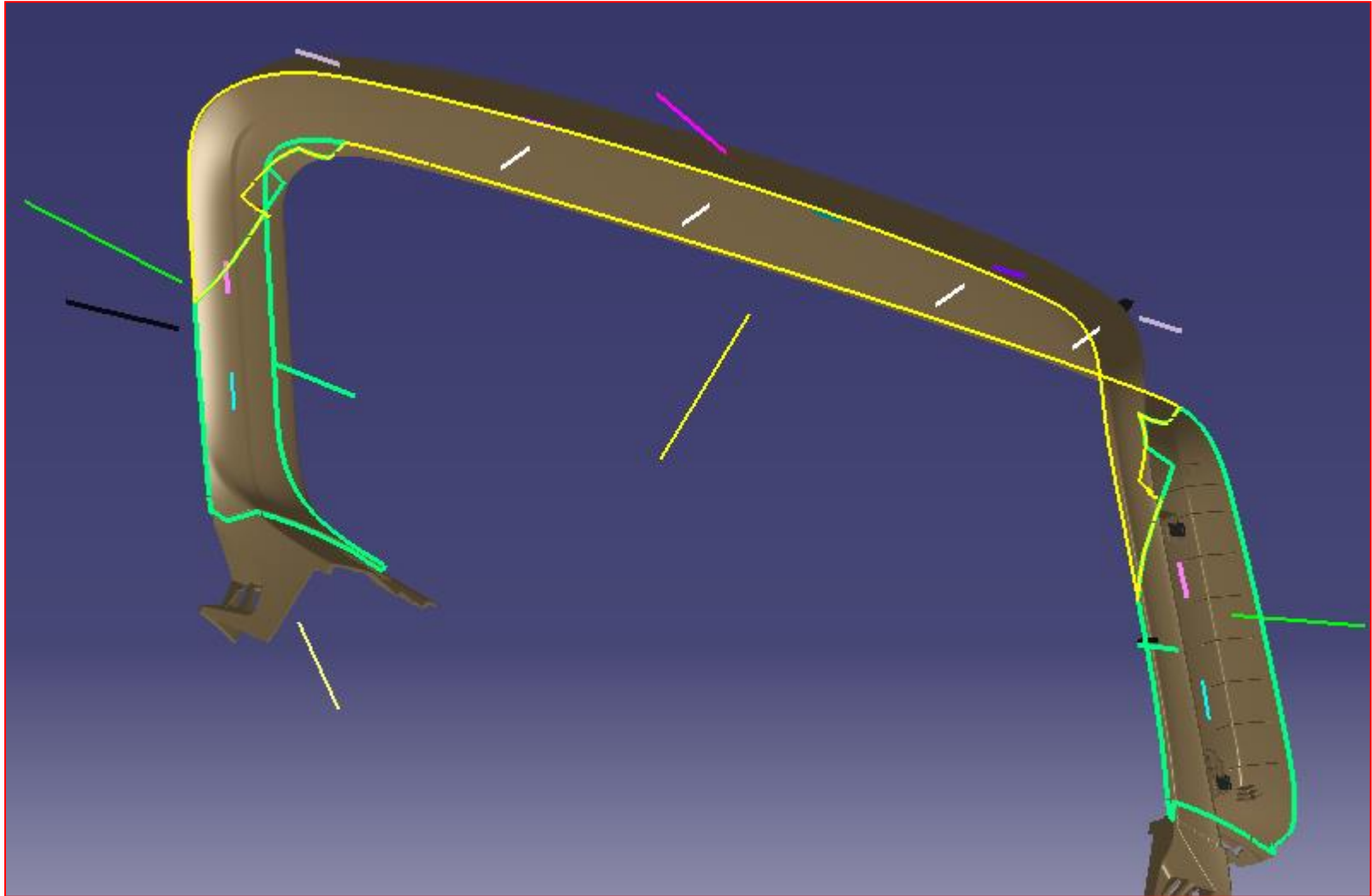

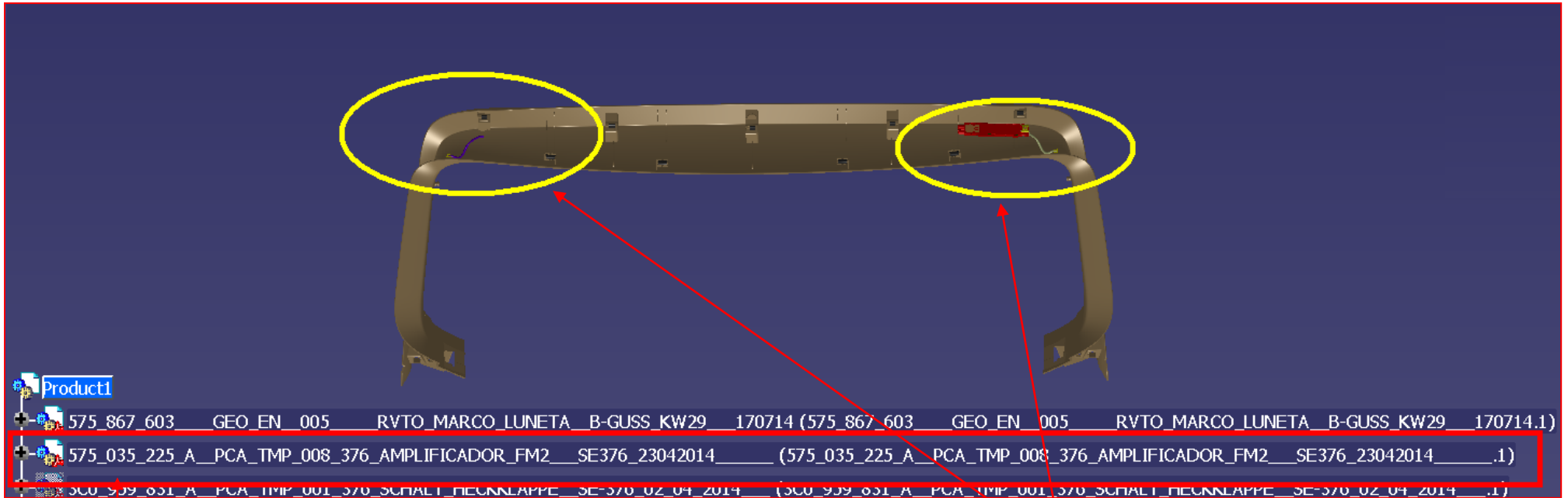

Analyze made against this part file name.

Affected areas

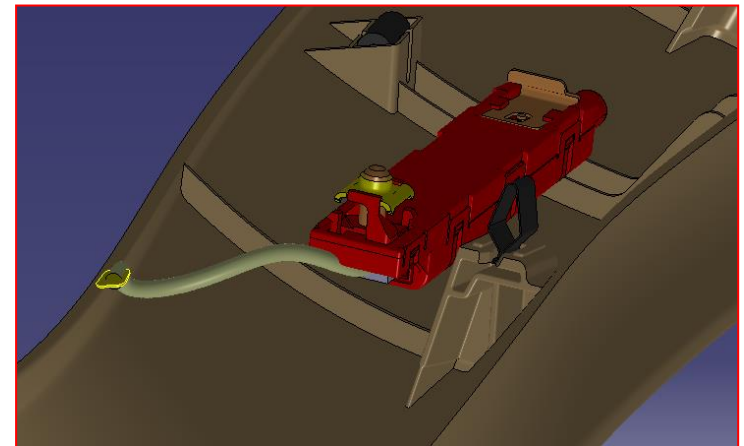

Minimum gap in X direction (real size) 8mm

o.k.

I will inform Seat in case is important

Cable in clash

Notice: the cable was find in no show.

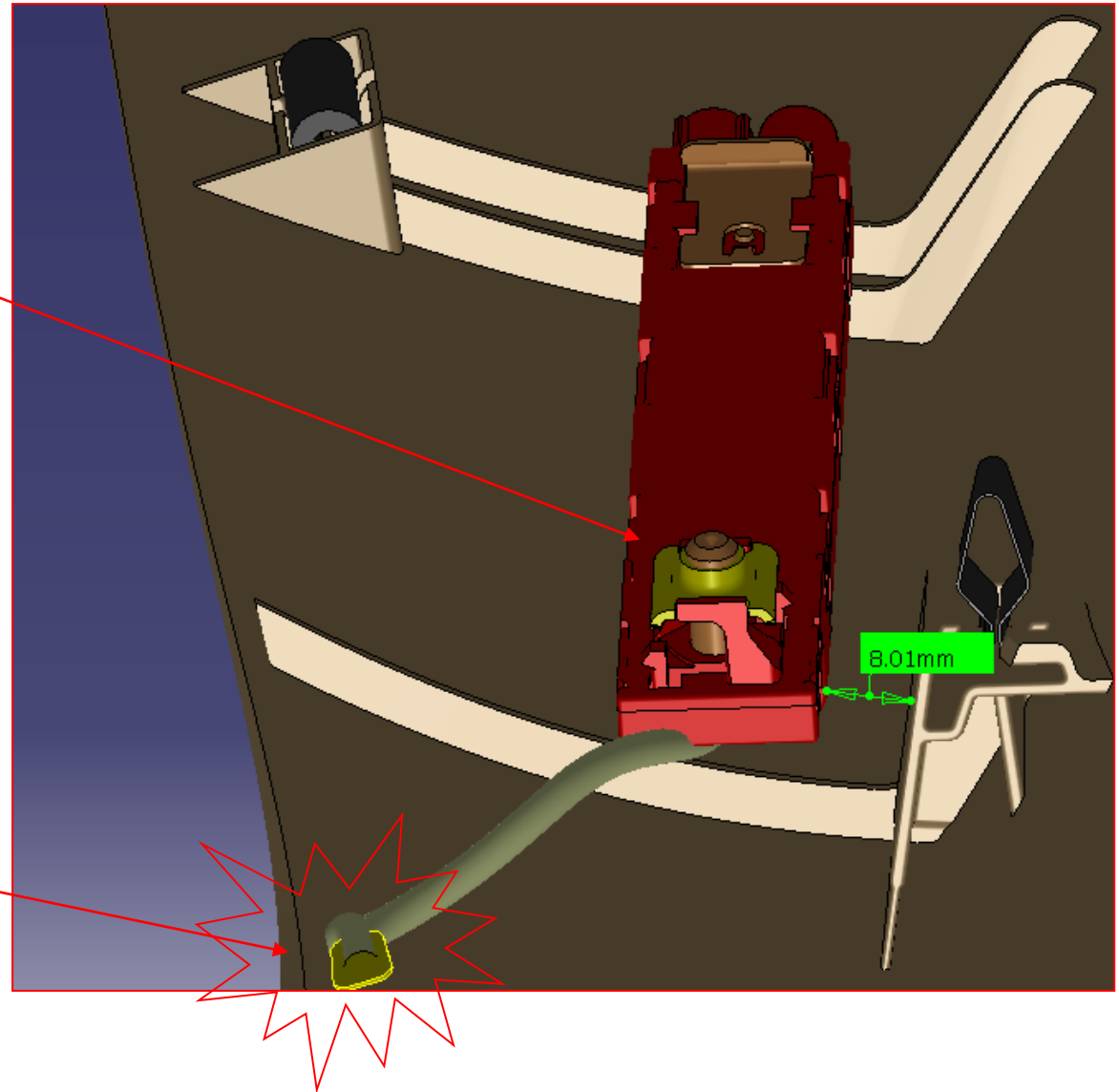

Minimum gap in Z direction (real size)  
5 mm (rib high 5mm)

o.k.

Cable in clash

Notice: the cable was find in no show.

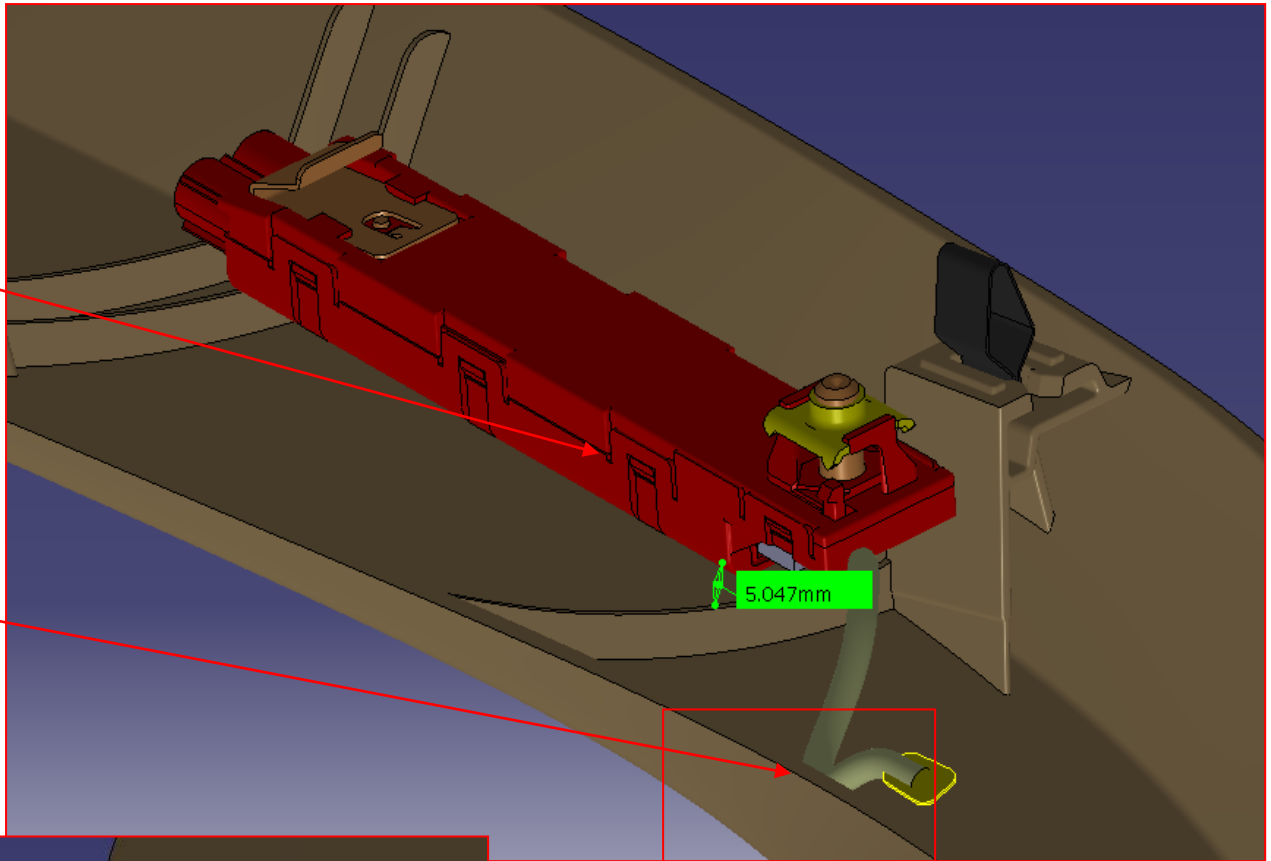

I will inform Seat in case is important

Clash max 0.21mm between upper part EOP and cable (EOP = end of part)

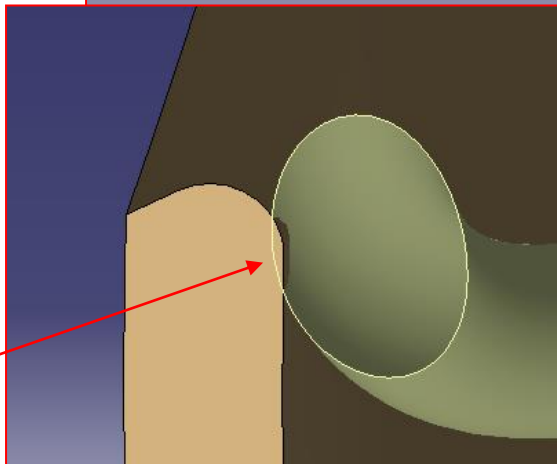

**SHOULD WE MAKE A CUTOUT IN ORDER TO AVOID THIS INTERFERENCE?  
CLERANCE ?**

No

General aspect with BIW in show



Next analyze made against this part file name.

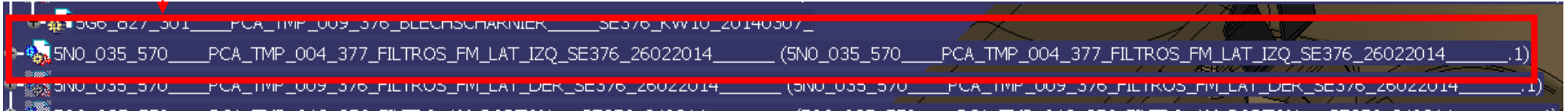

Minimum gap in X direction 4.0 mm against gass canal  
Minimum gap in Y direction 5.3 mm against B face

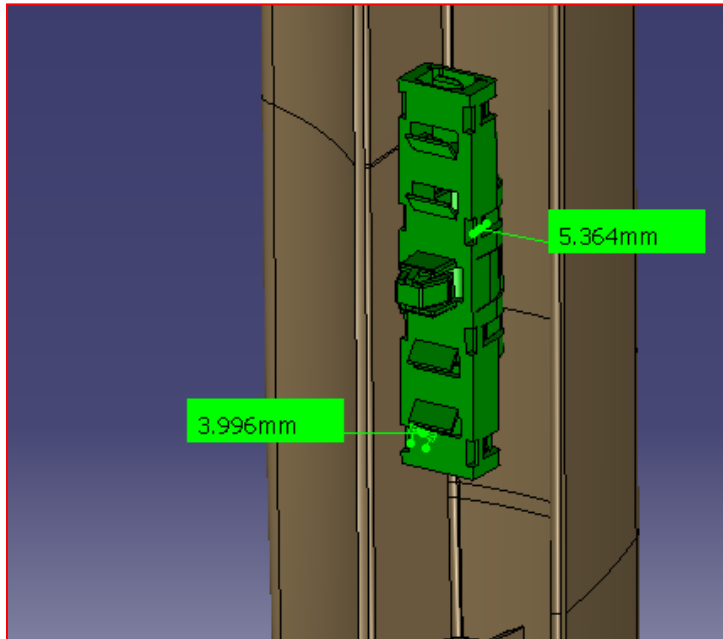

Affected area

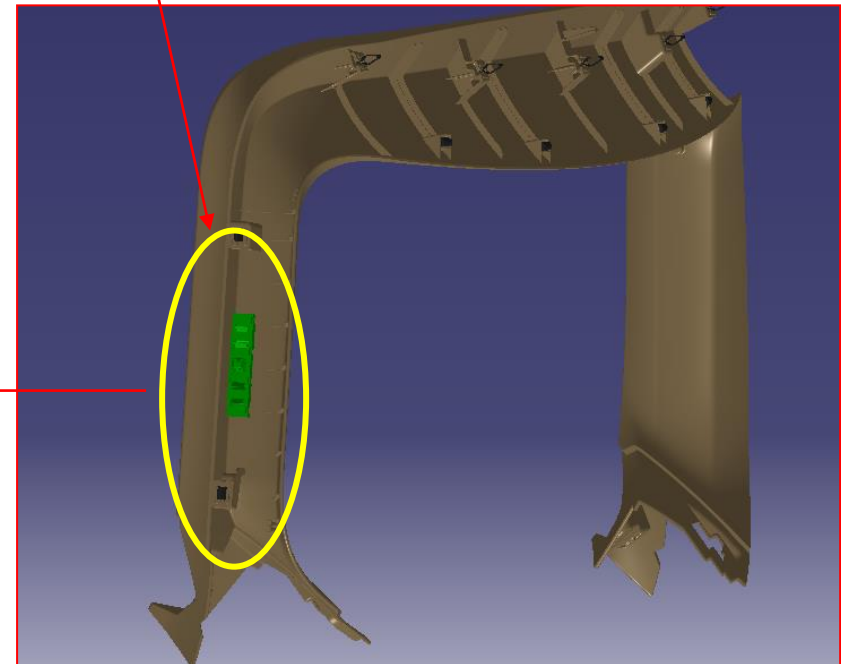

General aspect with BIW in show

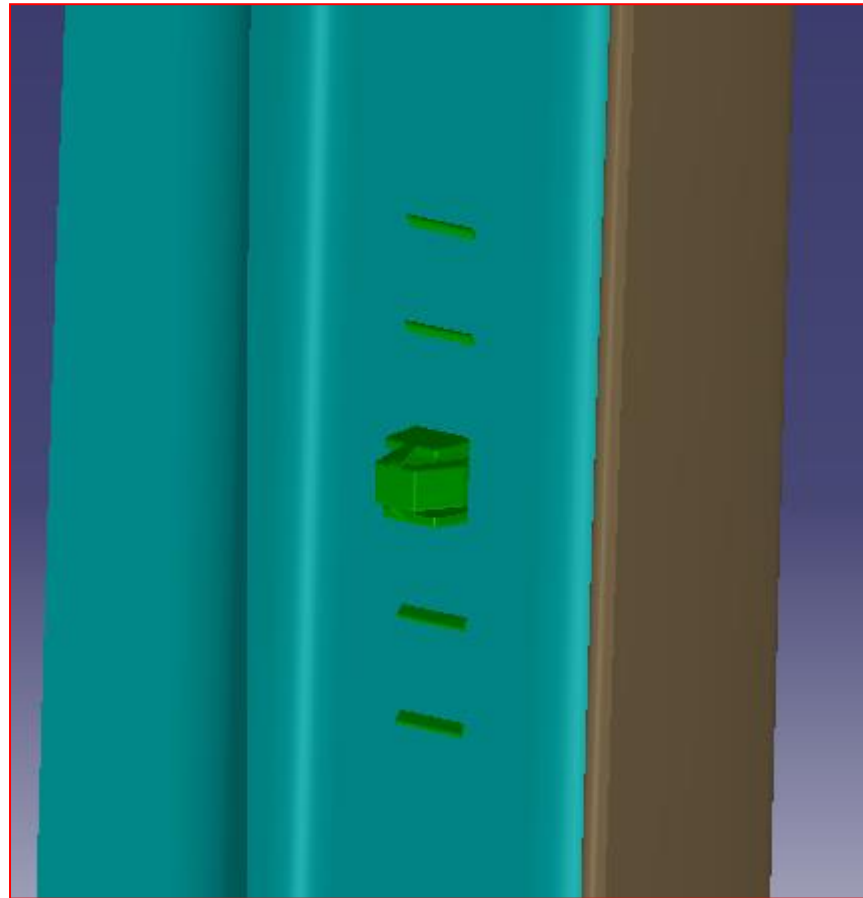

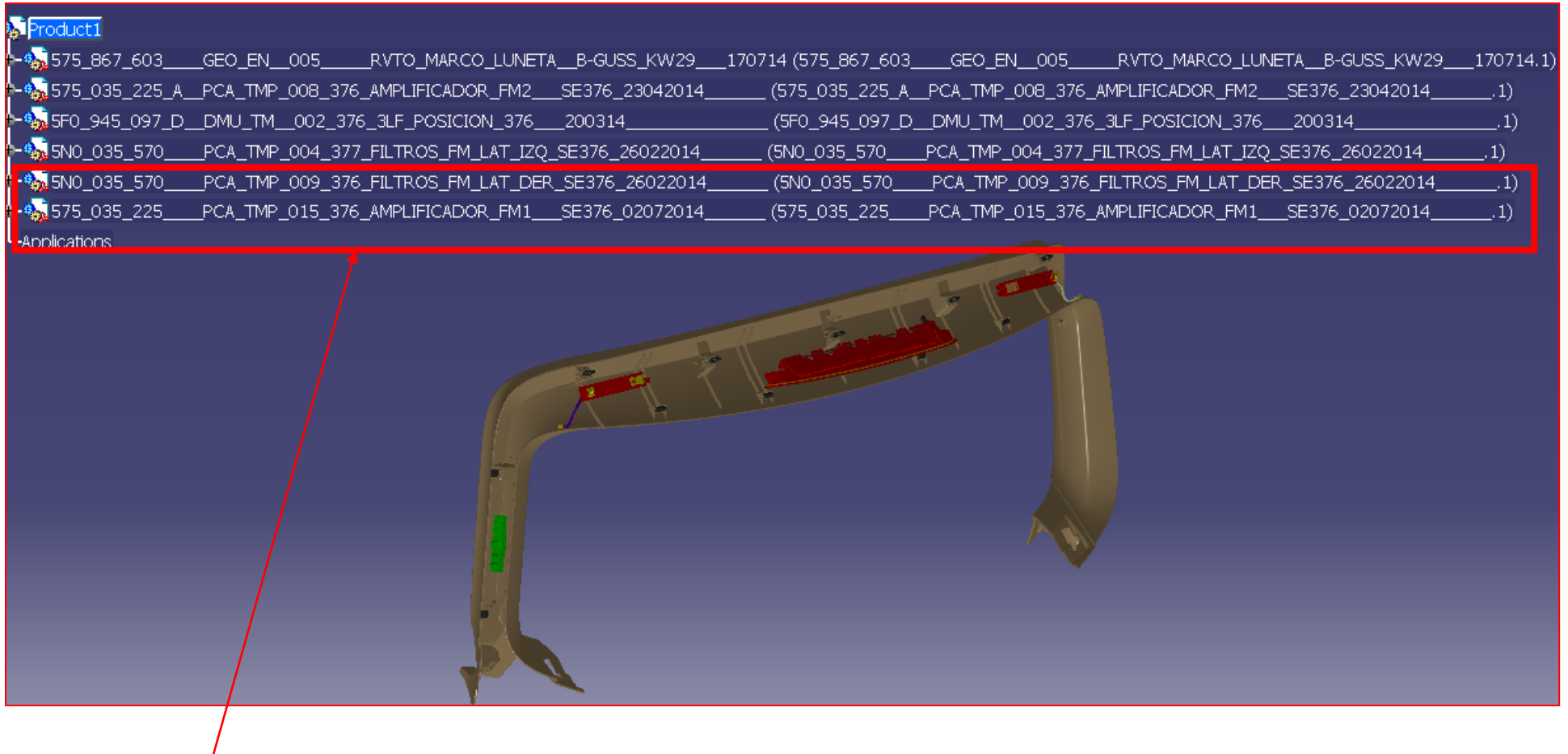

Analyze made against this parts file names.  
Simmetrical (the two prviews files) parts, same issues.



Next analyze made against this part file name.

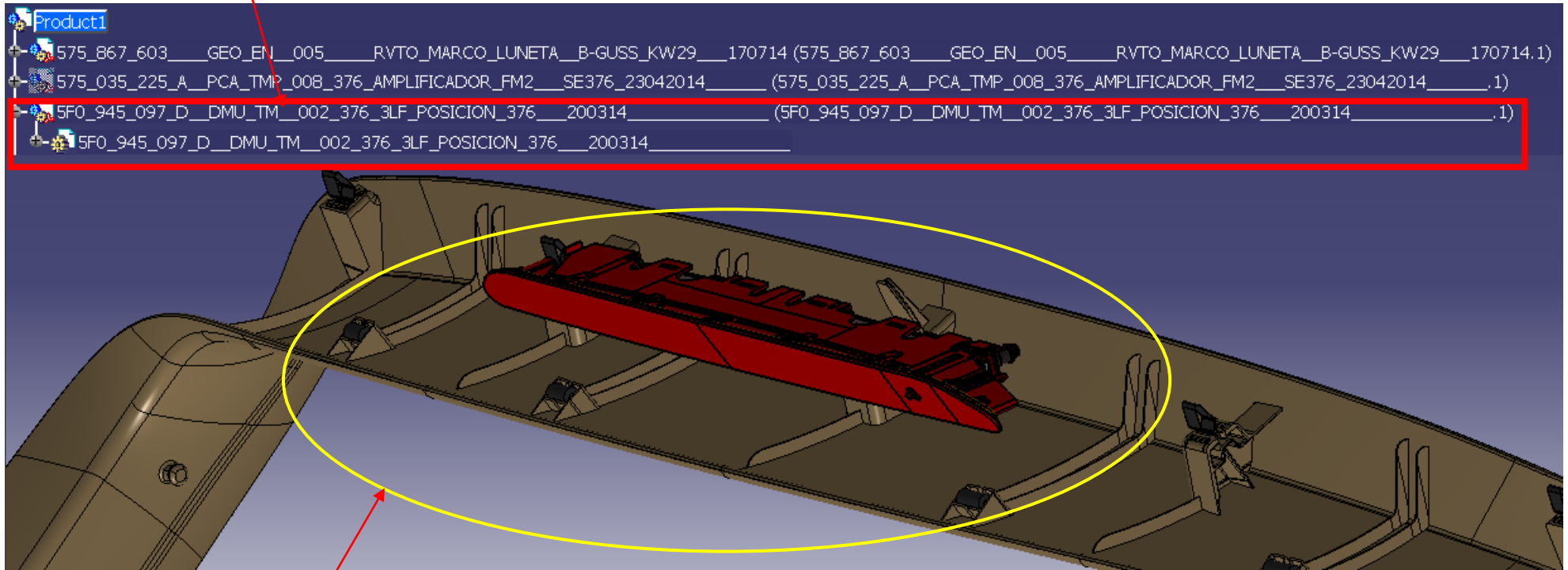

Affected area

General aspect with BIW in show

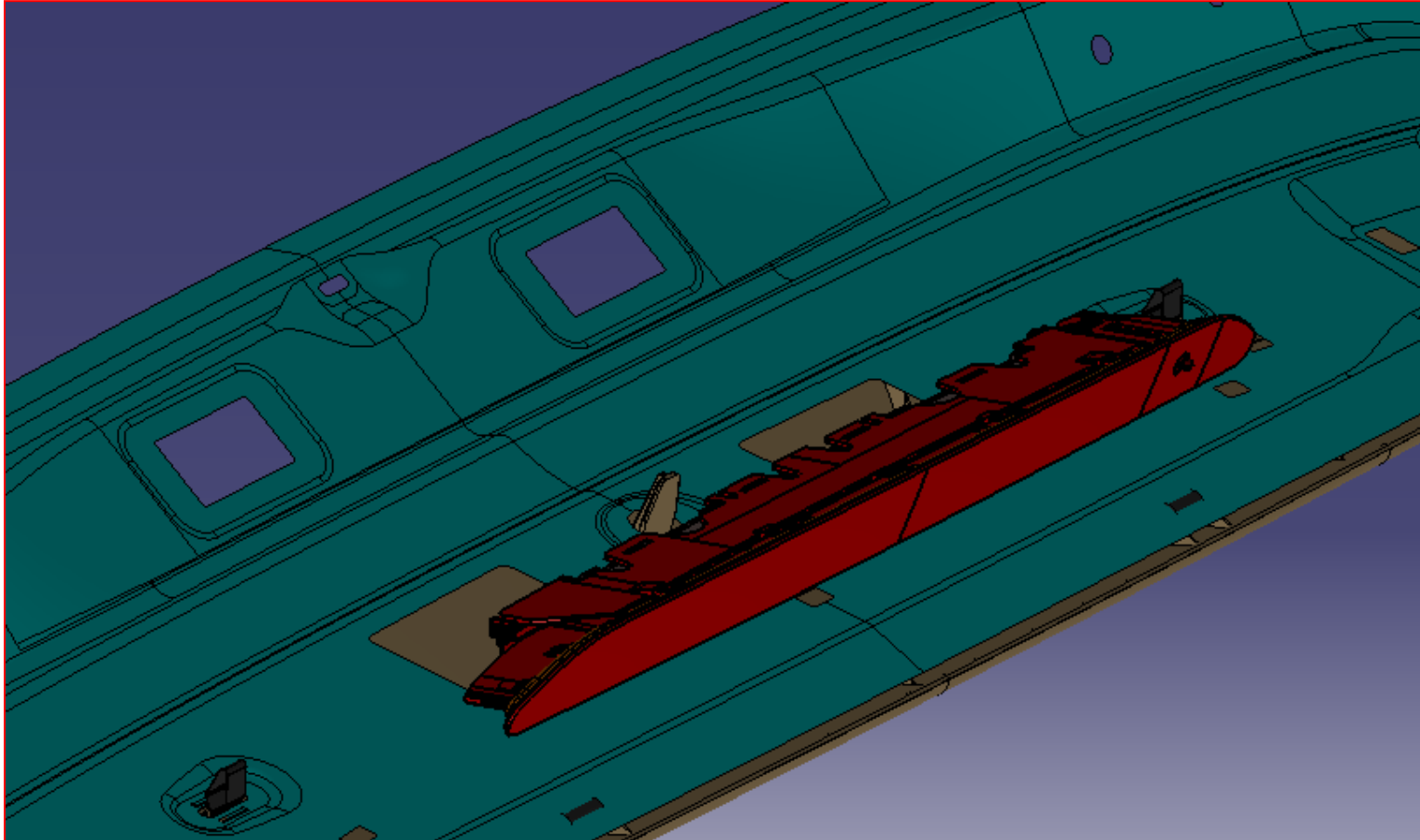

NO CLASH OR PROXIMITY UNDER 10mm

Next analyze made against this part file name .

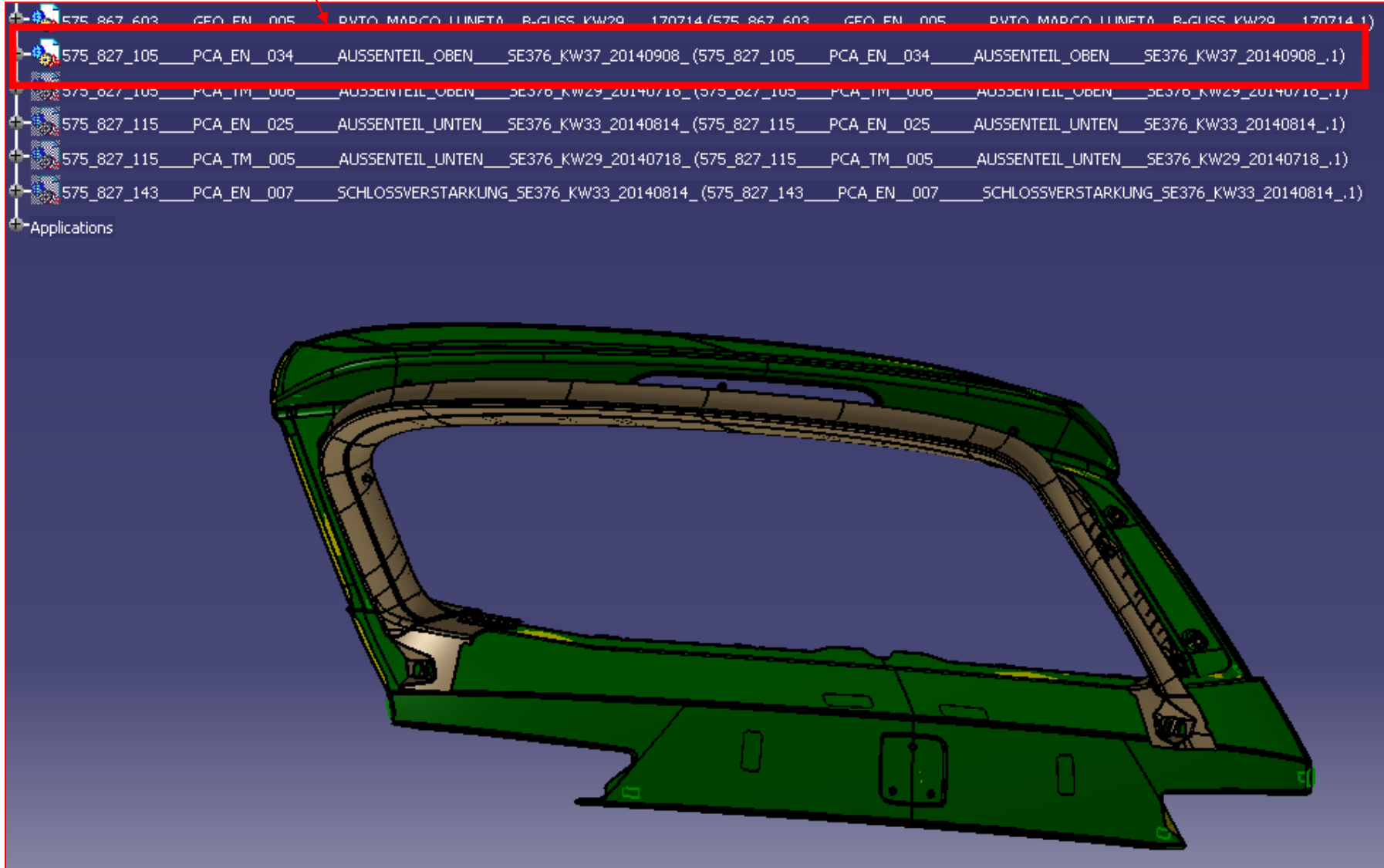

Minimum distance 0.24mm no clash

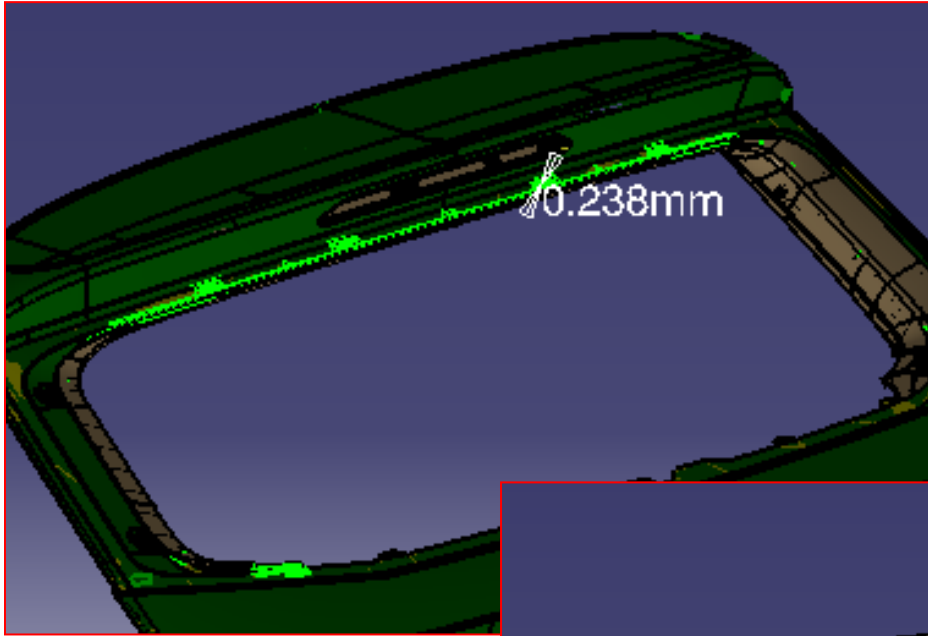

We should have clash as in this picture

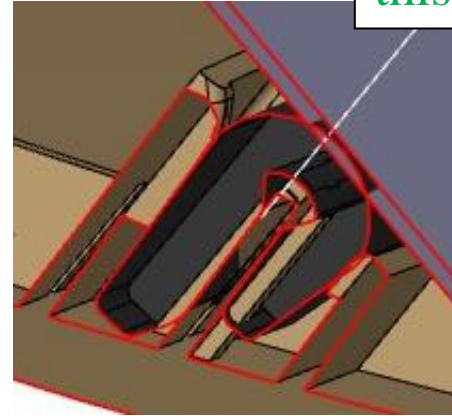

Clarence 0.2mm with GUMMIE

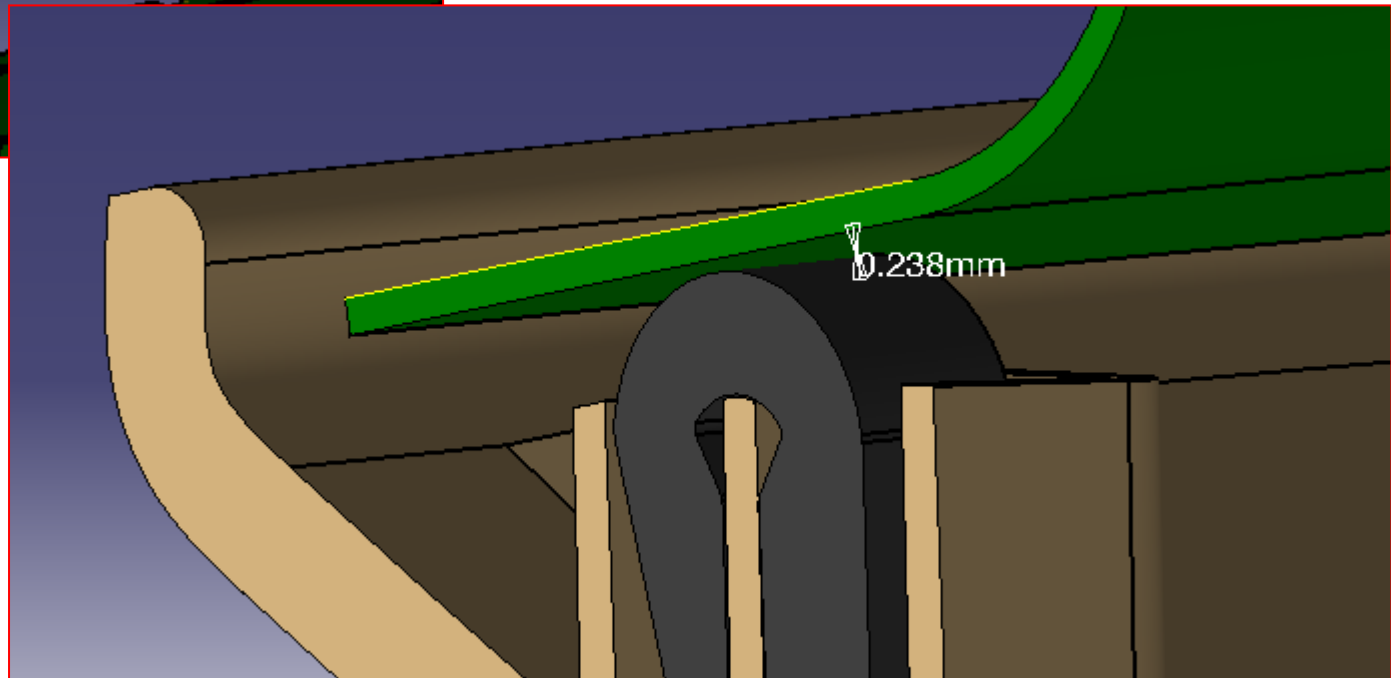

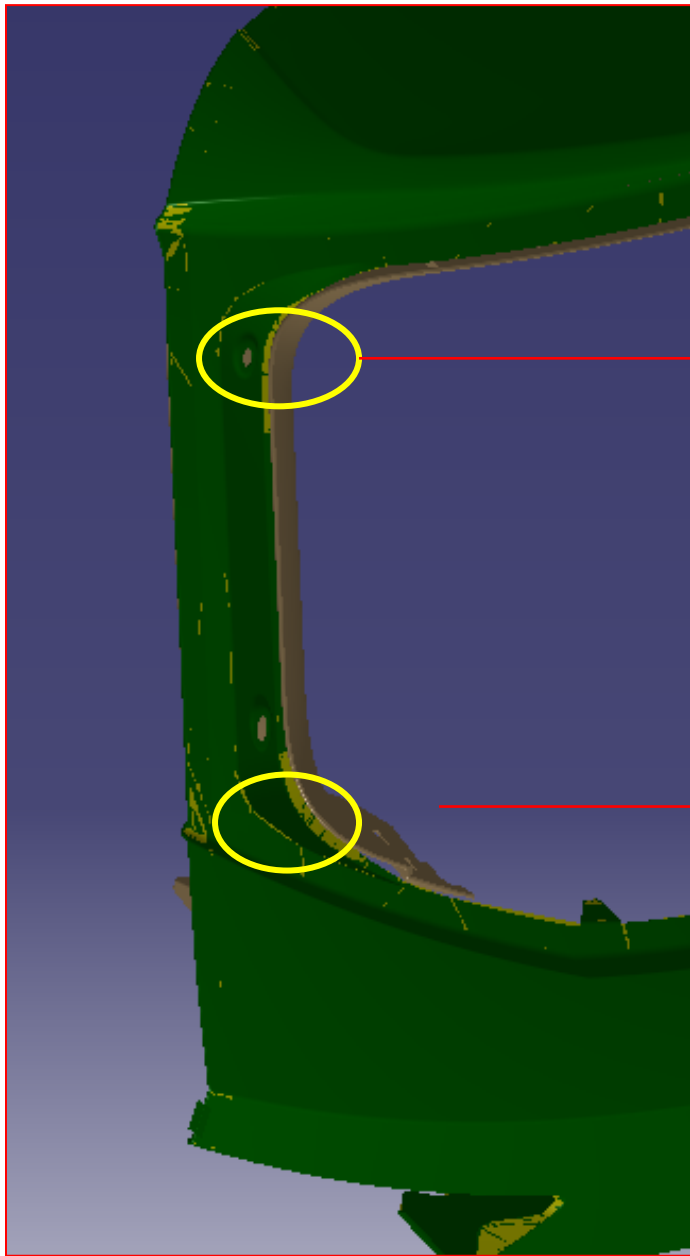

Clarence 0.5mm

***PLEASE SPECIFY IF 0.413 IT COULD BE CONSIDERED CORRECT, OR, WE SHOULD PASS TO 0.5mm.***

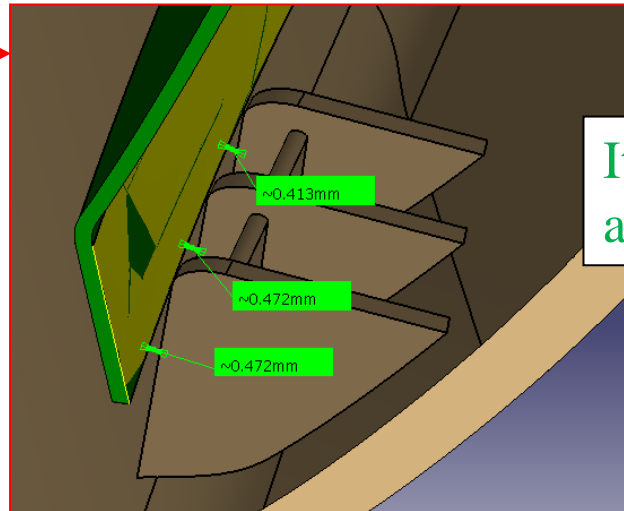

Clarence 0.4-0.5mm

It is correct. This will be an adjustment area

Side ribs proximity 1mm minimum.

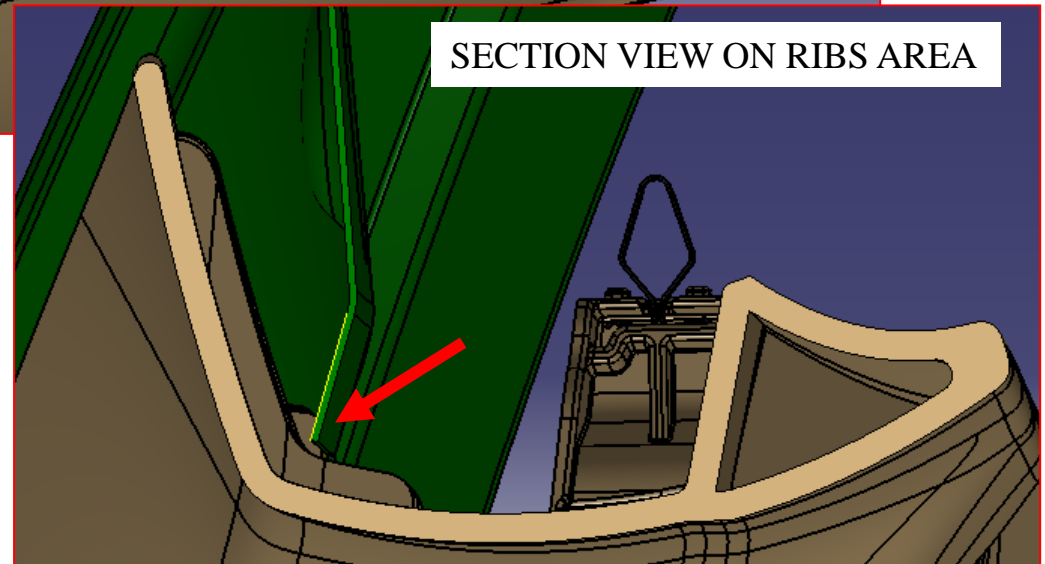

**PLEASE SPECIFY IF THE 1mm GAP IS GOOD ENOUGH (RIB HIGH 3mm).**

Please, get a minimum gap of 1,5mm.

**PLEASE SPECIFY IF THE 1.5mm GAP IS GOOD ENOUGH.**

o.k.

GAP 1.5 mm

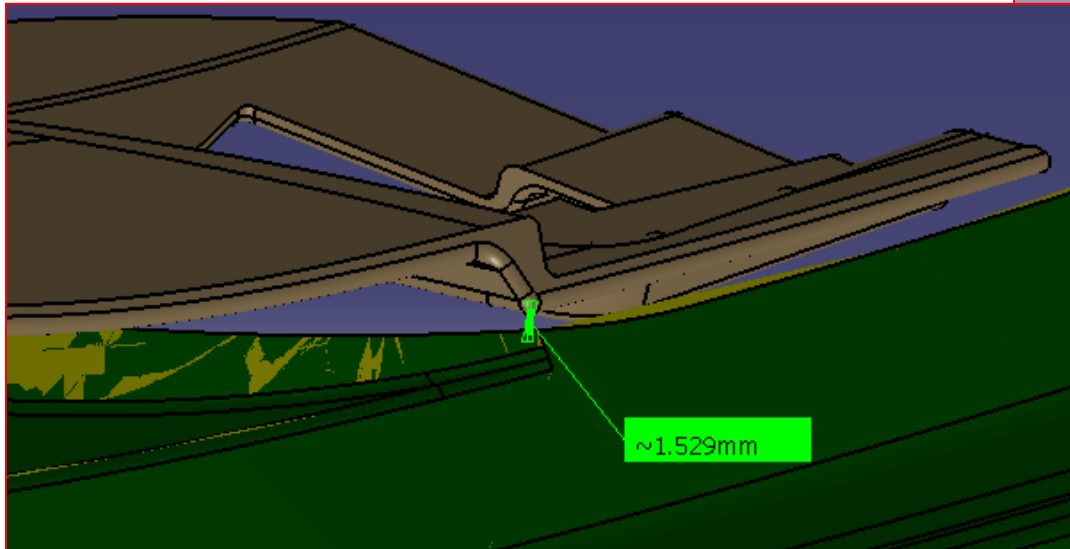
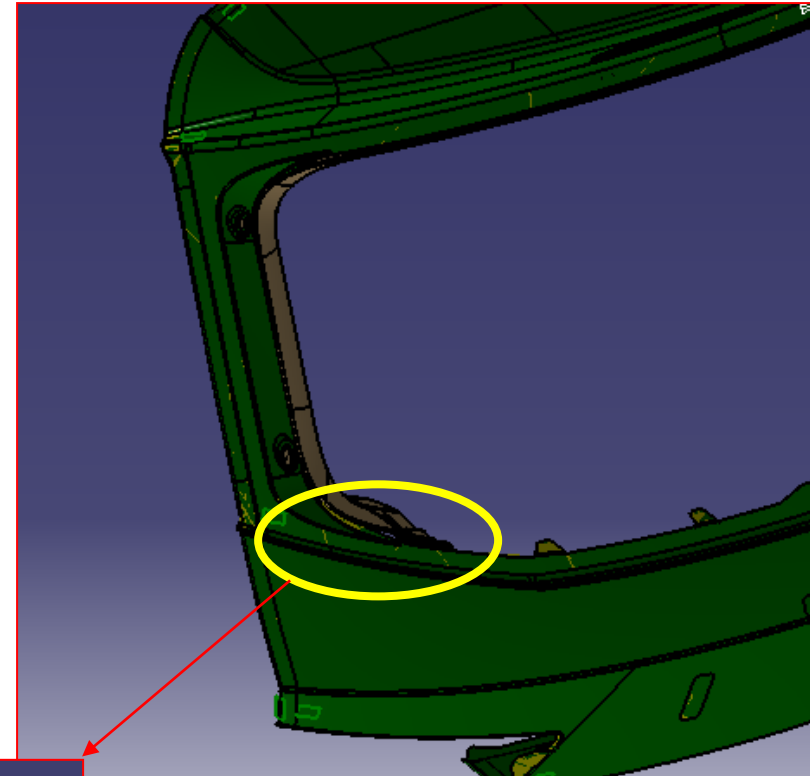

**PLEASE SPECIFY IF THE  
3 mm GAP IS GOOD  
ENOUGH.**

o.k.

3mm gap between B face and EOP of  
sheet metal part on the upper ligne.

